

The UIC International Sustainable Railway Awards (ISRA) recognise and honour key stakeholders in the railway sector who are leading innovation in social ('people'), environmental ('planet'), and economic ('prosperity') sustainability.

The awards showcase transformative work from stations to trains, from economic resilience to emergency pandemic response, from social outreach to supporting the local environment.

The gala ceremony for The UIC International Sustainable Railway Awards took place on 1 June 2022 at Radisson Collection Hotel, Berlin, Germany.



presents



THE UIC INTERNATIONAL  
SUSTAINABLE RAILWAY  
AWARDS 2022



This poster provides information about the ISRA 2022 winner in the category "Economy"  
"Best Multimodal Partnership"

## RFI - STATIONLAND

The RFI Station Department has developed a GIS-based platform called StationLAND, which is a web application that hosts a large number of data layers (approximately 300) useful to conduct analyses and studies for stations especially from a transport, territorial and socioeconomic point of view.

This platform currently represents the most powerful tool available nationwide to develop transport and mobility analyses aimed at studying and planning intermodal transport projects instrumental to enhancing the overall accessibility to rail transport and at identifying their environmental impacts. The development of this tool was possible thanks to a team and a wide network of:

- Managers
- Transport experts
- Aata analysts
- GIS analysts
- Institutional and non-institutional partners
- Local transport companies
- Local municipalities
- Shared mobility operators
- Ministry for Infrastructure and Sustainable Mobility

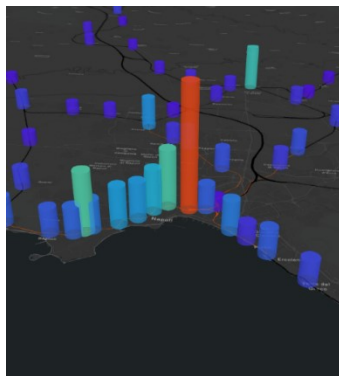
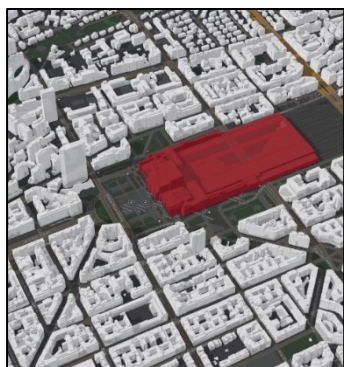

RFI is currently engaged in a process of transforming railway stations into real nodes of integrated and sustainable mobility. The goal is to strengthen the connections between the stations and the urban mobility system, also through the rearrangement of the external areas to improve the accessibility and livability of public spaces. Stationland is at the core of this process and is regarded as the enabling tool to implement this transformation.